

PLAT OF SURVEY

-OF-

COMMENCING AT THE NORTHEAST CORNER OF BLOCK 2 OF ROWENA PARK;
THENCE WEST 284.8 FEET, SOUTH 406.15 FEET TO THE HIGHWAY; THENCE
EASTERLY 54 FEET, NORTH 187.96 FEET, EAST 246 1/4 FEET TO THE EAST
LINE OF BLOCK 2; THENCE NORTH 203.97 FEET TO THE PLACE OF BEGINNING
IN SECTION 5, TOWNSHIP 1 NORTH, RANGE 17 EAST, TOWNSHIP OF LINN
WALWORTH COUNTY, WISCONSIN.

KROTT SURVEYING INC.

N3705 WILLOW BEND LANE
LAKE GENEVA WI. 53147
PHONE # (262)248-3697
FAX # (262)249-0639



LEGEND

- FOUND IRON PIPE
- SET IRON BAR
- ⊕ CONCRETE LID
- ⊙ VENT
- ⊙ 4" DIA. P.V.C. PIPE
- ⊙ UTILITY POLE
- OVERHEAD WIRES
- DECIDUOUS TREE
- ⊙ CONIFER TREE
- ⊙ RECORDED AS
- TAX ID # IRP00025
- JOB # 11-036

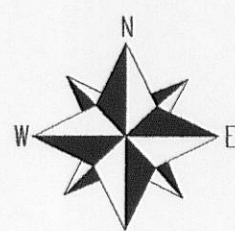

SCALE 1"=30'

NOTE: BEARINGS ARE REFERENCED TO PREVIOUS SURVEYS OF RECORD.

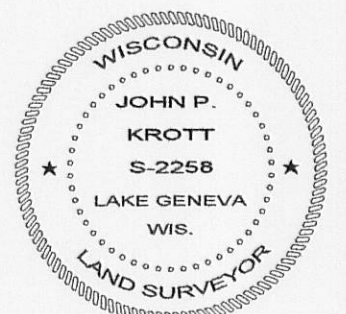
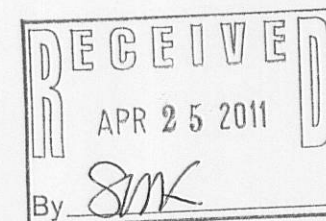

I have surveyed the above-described property and the above map is a true representation thereof and shows the size and location of the property, its exterior boundaries, the location and dimensions of all structures thereon, fences, apparent easements and roadways and visible encroachments, if any.

This survey is made for the exclusive use of the present owners of the property, and also those who purchase, mortgage, or insure the title thereto within one (1) year from date hereof, and as to them I warrant the accuracy of said survey map.

DATE OF LAST REVISION: 4/01/2011

DATED THIS 24th DAY OF MARCH 2011.

John P. Krott
JOHN KROTT S - 2258
Wisconsin Registered Land Surveyor
(original if signed in red)